



*Everyday Destinations. Extraordinary Locations.*

The Shops at Todos Santos is a collection of street-front retail encompassing an entire city block in the heart of Concord, California, one of the San Francisco Bay Area's strongest growth markets. Ideally situated adjacent to Todos Santos Plaza, the city's primary community gathering spot, this property also benefits from its proximity to the BART mass transit station and 1.5 million square feet of office users within a five-minute walk. With key tenants such as The Old Spaghetti Factory, Bank of America, Chipotle and Peet's Coffee, Shops at Todos Santos offers needs-based retail in an urban setting.

# SHOPS AT TODOS SANTOS

CONCORD, CALIFORNIA | TOTAL SQUARE FEET: 40,919



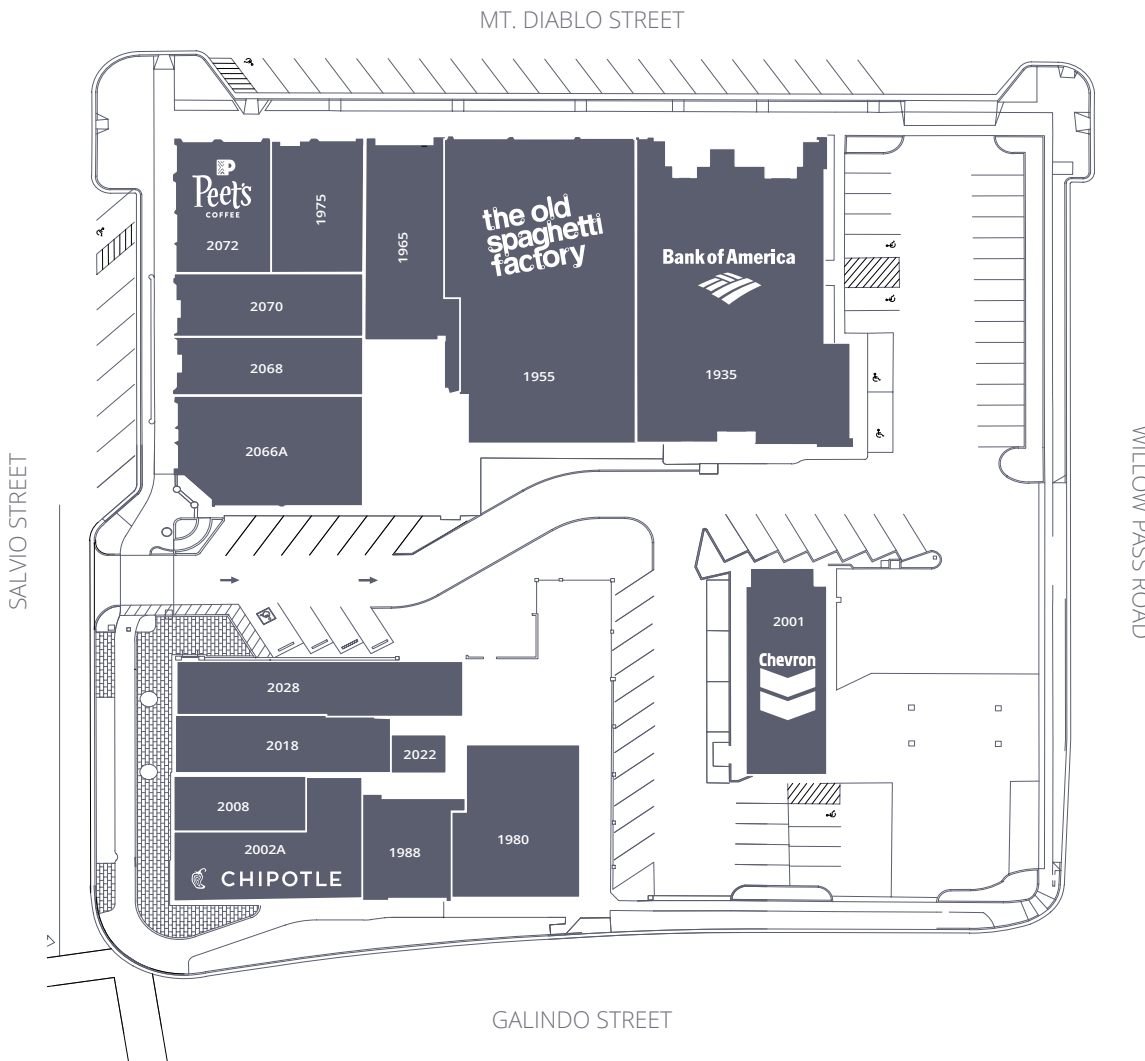

# SHOPS AT TODOS SANTOS

1980 Galindo Street  
 2001 Willow Pass Road  
 1925, 1935, 1955, 1965 & 1975 Mt. Diablo Street  
 2002-2072 Salvio Street, Concord, CA 94520



**AVERAGE  
DAILY TRAFFIC**

**17,000** ADT

Salvio Street & Concord Avenue

**6,000** Daily Commuters

Concord BART Station

**TOTAL SQUARE FEET: 40,919**

## LEASING MANAGER

Mike Shekoyan

P 949-662-2077

C 310-909-9589

mshekoyan@trcretail.com

License #02023585

## PROPERTY MANAGER

Shannon Naraghi

P 925-241-4023

C 916-693-2504

snaraghi@trcretail.com

License BRE #02019107

## DEMOGRAPHICS

	1 MILE	3 MILE	5 MILE
Population	26,057	131,816	261,711
Average HH Income	\$85,117	\$115,038	\$137,374
Workplace Population	20,871	107,958	215,232